

WILLY WHITE

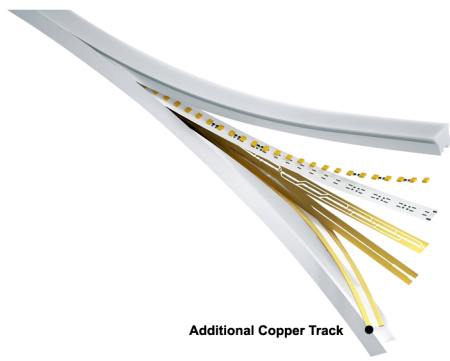

DESCRIPTION:

WILLY WHITE Horizontal bend Neon Flex lighting features, designed to maintain reliable performance even in the event of a broken board. By incorporating an additional layer of copper foil on the back of the flexible printed circuit (FPC). This not only ensures greater durability but also provides superior thermal management, as the copper layer acts as an efficient heat sink to dissipate heat from the LEDs. The result is a longer-lasting, more robust lighting solution that delivers both performance and reliability in demanding applications. Control mode : ON/OFF, DALI, Phase Cut, 0/1-10V.

TECHNICAL DETAILS:

Power : 8-15W/M
Voltage : DC24V
Efficiency : 80lm/W
CRI >90
Length/Reel : 5M
Cutting length: 50mm
Led Qty : 140LEDs/M
Working Temperature : -25~60°C
Storage Temperature : -25~70°C
Voltage Range : 23 ~25V dc
Reverse Voltage : 25V dc
Warranty : 5 years

LUMENS PER METER:

CCT	8W	12W	15W
2700K	608lm	912lm	1140lm
3000K	640lm	960lm	1200lm
4000K	672lm	1008lm	1260lm
5000K	675lm	1013lm	1266lm
5700K	679lm	1018lm	1272lm
6500K	691lm	1037lm	1296lm

INSTALLATION : Horizontal Bend

Product Code : 7601212

DIMENSION:

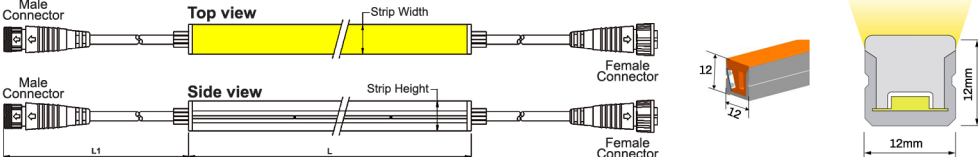

LIGHT DISTRIBUTION:

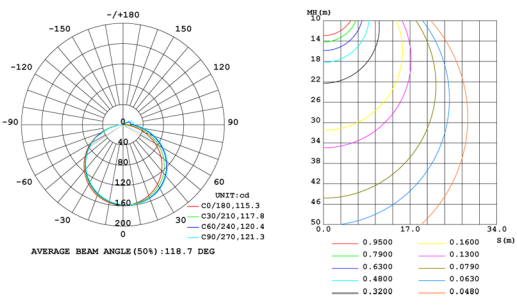

BENDING:

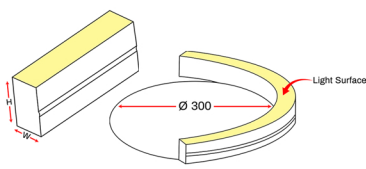

End cap

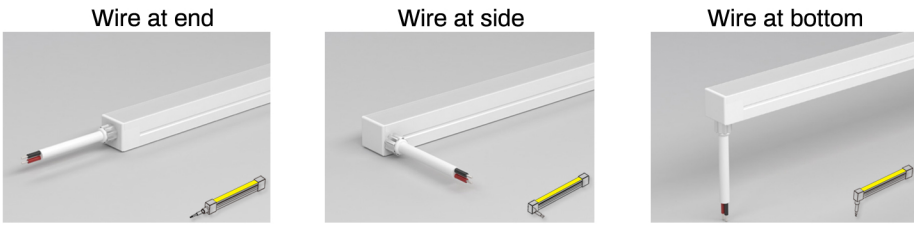

Standards

- EN 60598-1
- EN 60598-2-2
- EN 60598-3-2

Order Code Ex : 7601212	15	27
Product Code 7601212	Power 08-8W 12-12W 15-15W	CCT 27-2700K 30-3000K 40-4000K 50-5000K 57-5700K 65-6500K

Pluxb luminaires are developed with globally recognized and tested components suppliers, however as per international standards tolerance in initial flux and connected load is at $\pm 5\%$. Unless stated otherwise, the values apply to an ambient temperature of 25°C

ACCESSORIES

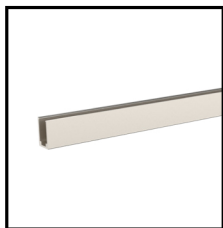

Aluminium Profile
Order Code: 7601212-01
Dimension: L1000xW14xH14.5mm
Material: aluminium
Color: silver

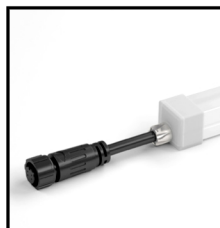

End Cap 2PIN
Order Code: 7601212-06
Color: white
Cable entry: front/side/bottom
Picture: front



Curved Profile
Order Code: 7601212-02
Dimension: L1000xW13xH9mm
Material: stainless steel
Color: silver



Closed End Cap
Order Code: 7601212-07
Material: silicone
Color: white

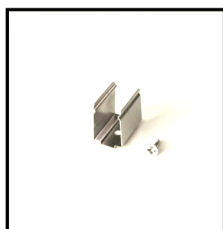

Mounting Clips
Order Code: 7601212-03
Dimension: L30xW14xH14.5mm
Material: stainless steel
Color: silver
Each meter led strips needs
2 clips + 2 screws



IP67 T Type Connector
Order Code: 7601212-08
Wire Gauge: 0.326mm²/22AWG
Protection: IP67 (Mated)



IP67 Connector 2PIN
Order Code: 7601212-04
Wire gauge: 0.326mm²/22AWG
Protection: IP67 (Mated)
Connector type : Male



Scissor
Order Code: 7601212-09



IP67 Connector 2PIN
Order Code: 7601212-05
Wire gauge: 0.326mm²/22AWG
Protection: IP67 (Mated)
Connector type : Female

ADDITIONAL INFO.

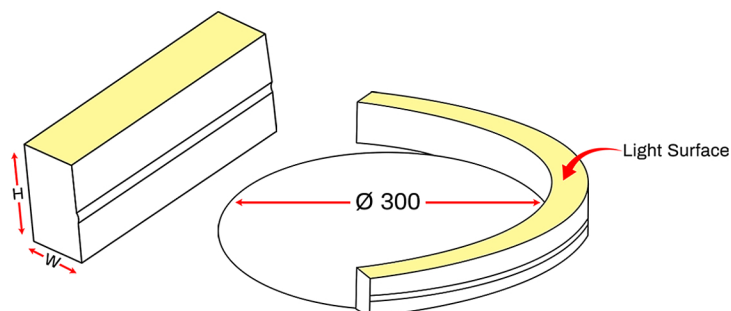

- ▶ Please light it up for a quick check before installation.
- ▶ Bending diameter of SWILLY WHITE 1212 is 300mm, do not bend to Top direction, or bend too sharp or twist. If bend it wrongly, PCB inside will be damaged and the lighting fixture will not turn on.
- ▶ During installation, please make sure there are at least two workers to cooperate together and strictly follow the instruction manuals.
- ▶ Warranty: All LED light are warranted to be free from defects in product itself for 5 years from the date of purchase. This warranty does not cover failures due to abuse, misuse, improper handling, act of nature, negligence, normal wear, accidental damage, repairs made by the purchaser or incorrect voltage conditions.

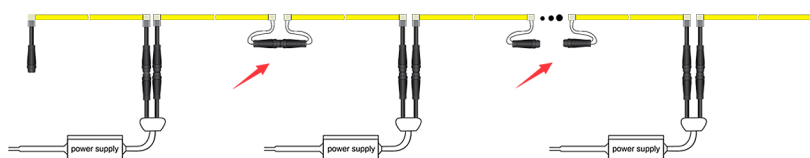

Note:

- 8W/M Max. 10mtr run length to single side feed.
- 12W/M Max. 10mtr run length to single side feed.
- 15W/M Max. 7mtr run length to double side feed.

-The given data are typical values due to the tolerances of the production process and the electrical components, values for light output and electrical power can vary up to 5%.

WIRING DIAGRAM

ON/OFF

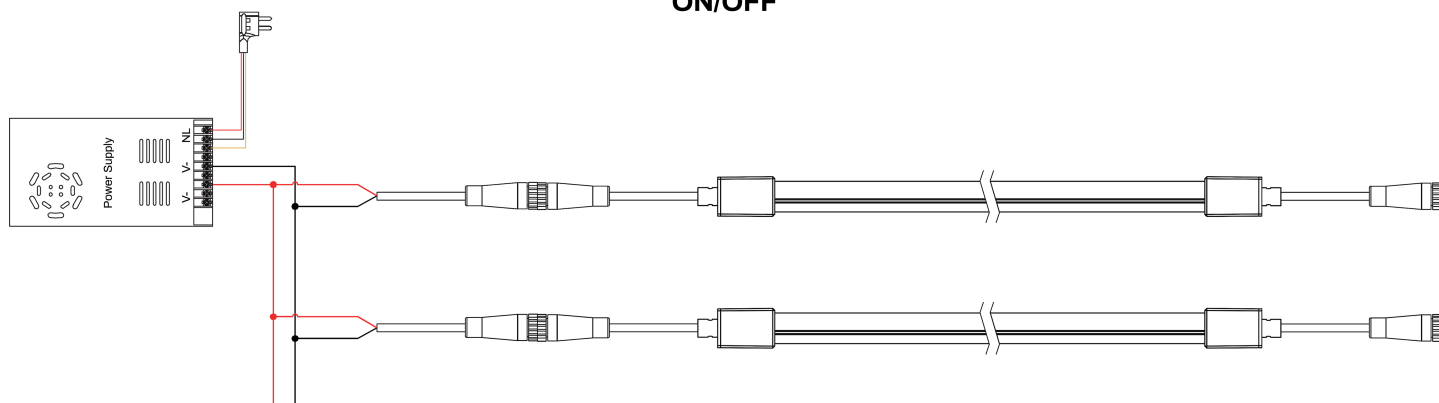

1. DALI

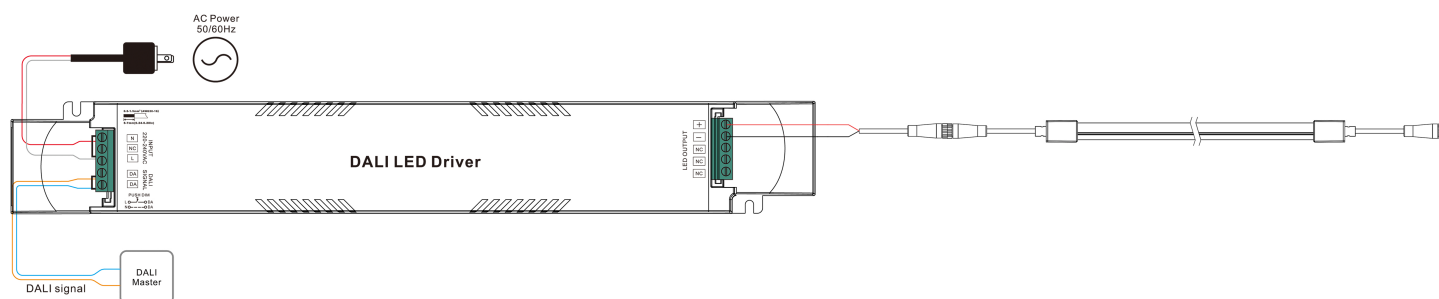

2. WITH PUSH DIM

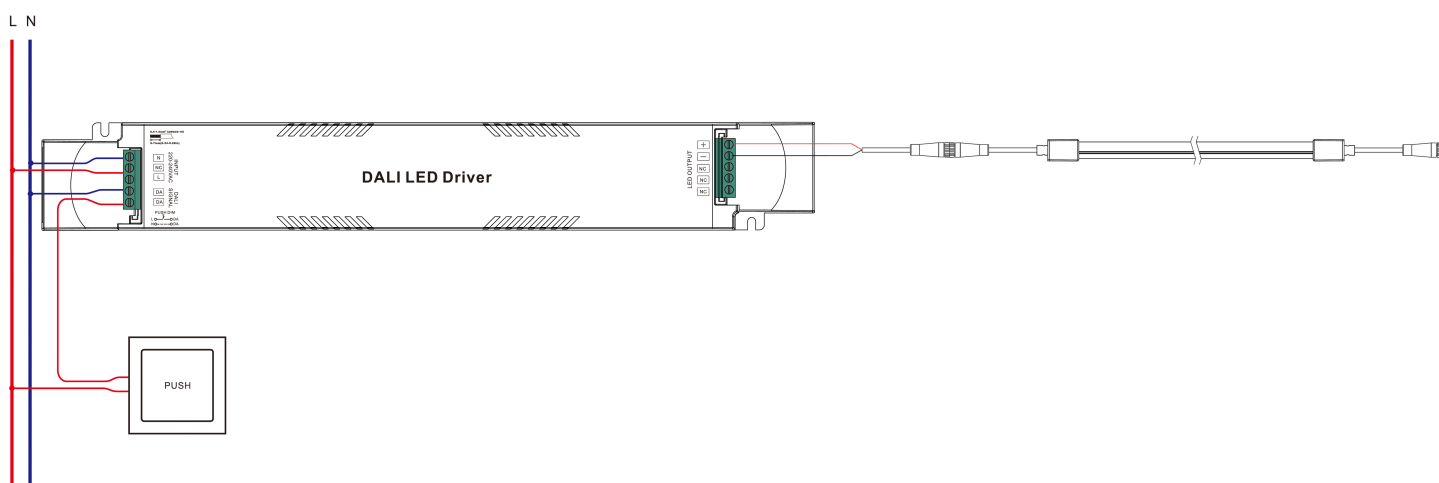

WIRING DIAGRAM

0/1-10V

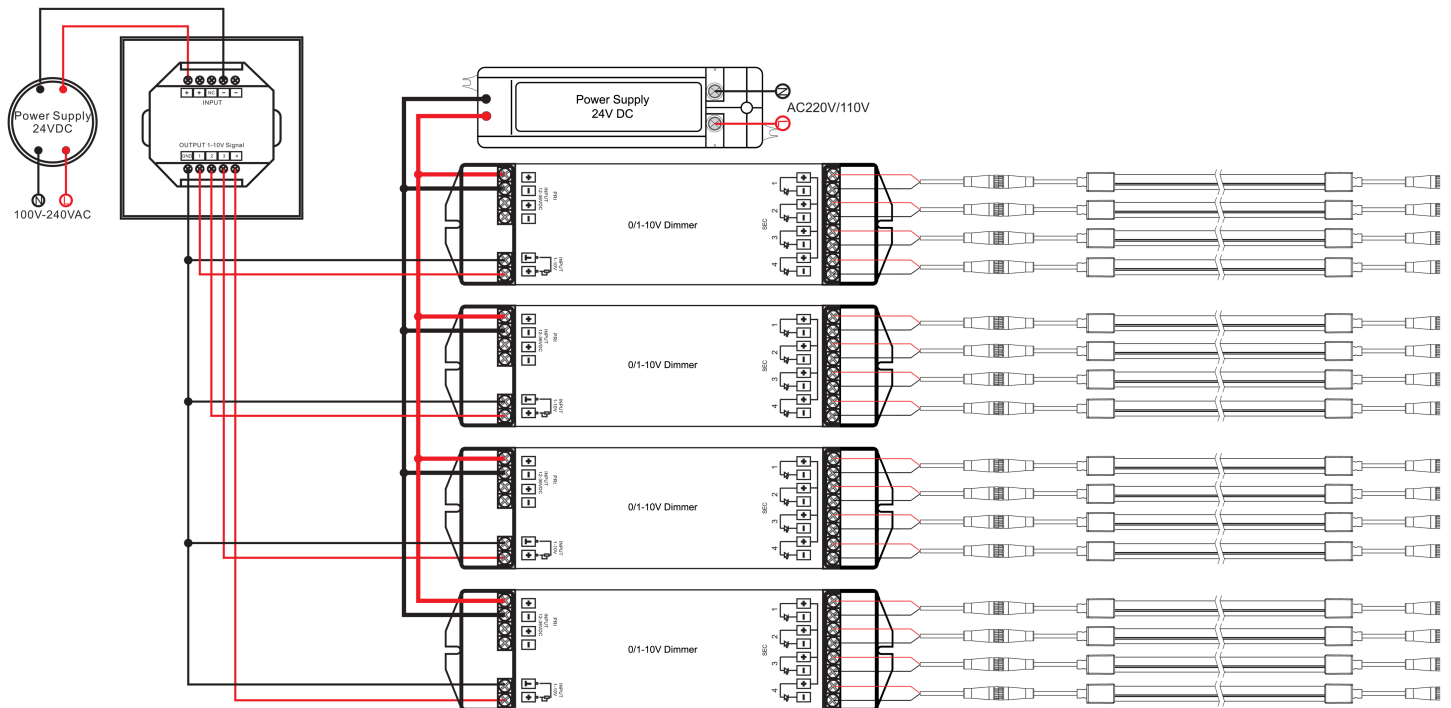

PHASE CUT

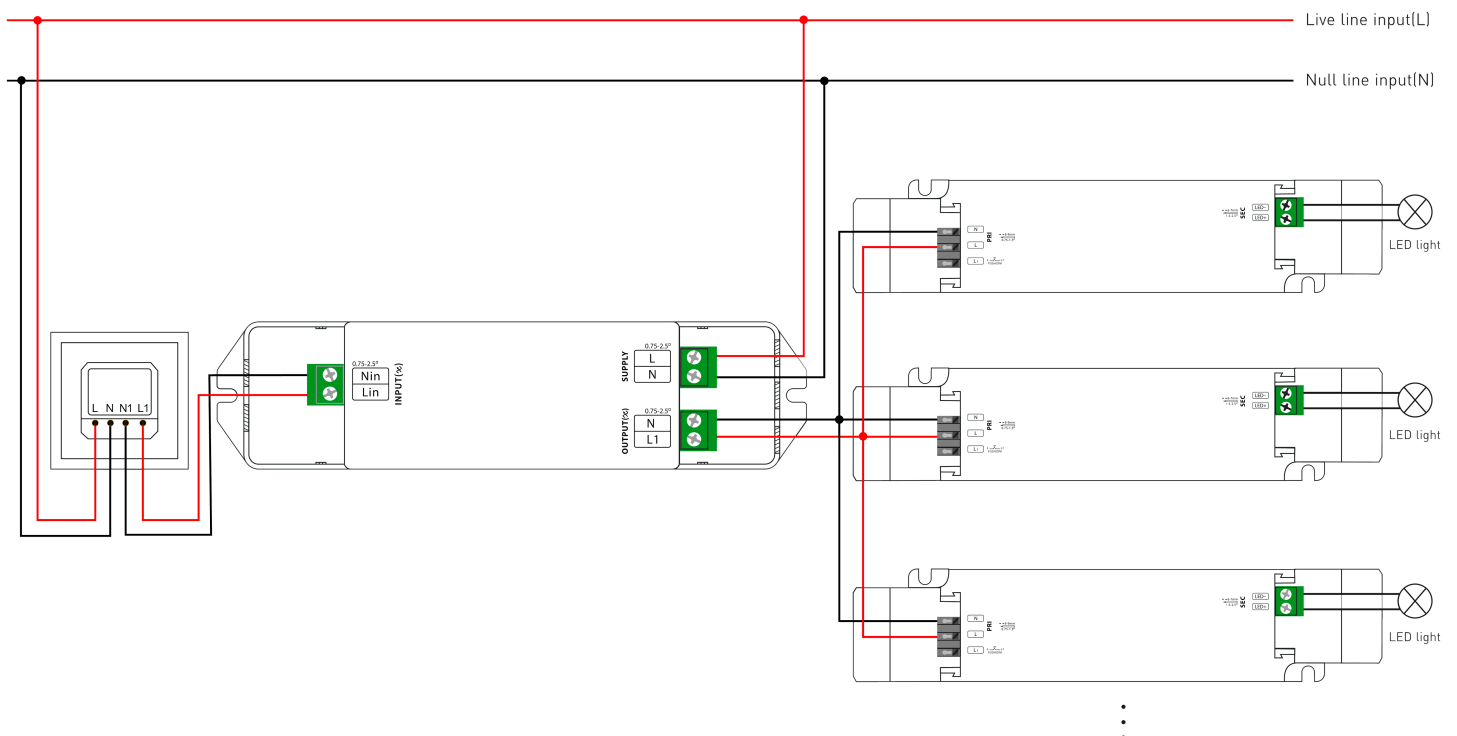

GENERAL MOUNTING

LED neon flex can be fastened to surfaces using appropriate accessories available from distributor. Please refer to data sheets or contact technical support for a copy. The use of glues and resins as fixing agents should be avoided. Use of glues and resins may invalidate the warranty of the product unless its use is agreed in writing by distributor as part of a detailed project specification.

The images indicate one type of fixing available in the accessories range. The different fixings serve obvious purposes, however when in doubt technical support should be contacted.

Quantities of accessories and fixings are dependent on the type and its effect on the variant it's being used with. Care should be taken to ensure drooping is avoided, and to ensure that is fastened adequately to avoid stresses on itself.

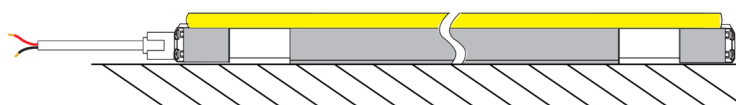
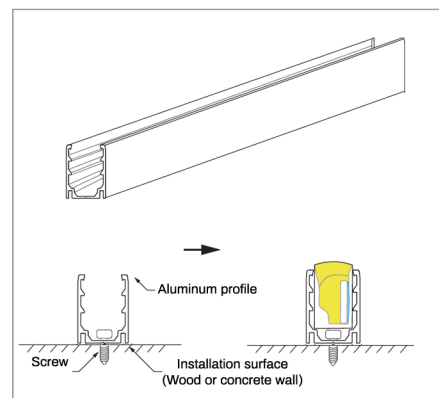

Press the flex light into mounted aluminum channel in one direction.

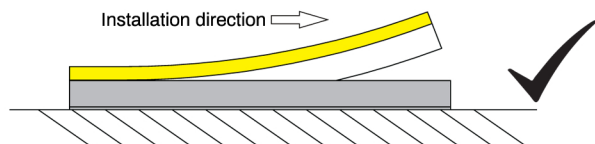

Incorrect installation like below picture could lead to light failure.

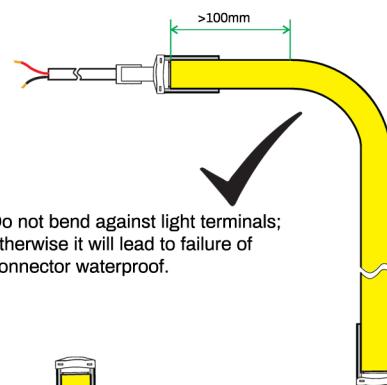
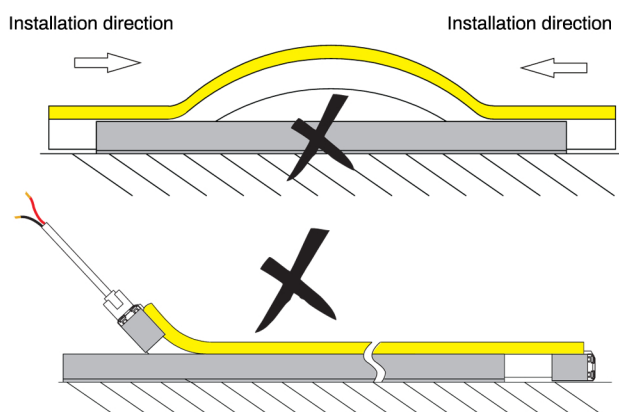

Do not bend against light terminals; otherwise it will lead to failure of connector waterproof.

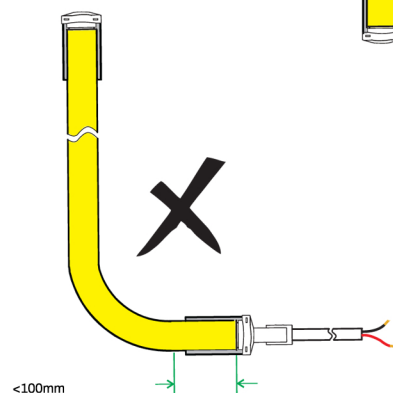

Ensure the feeding cable not bear force, keep the head 10mm in natural loose.

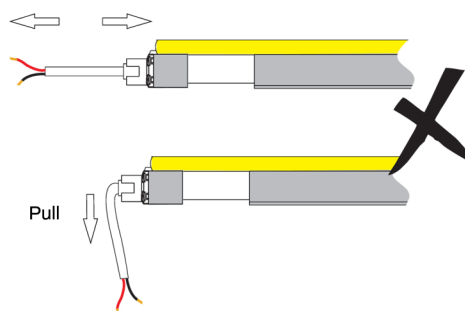
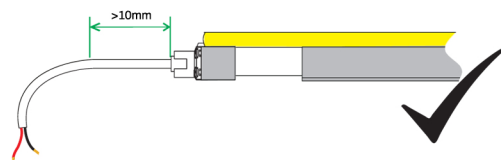

Mount the cable junction in hermetic enclosure like waterproof junction box in outdoor application.

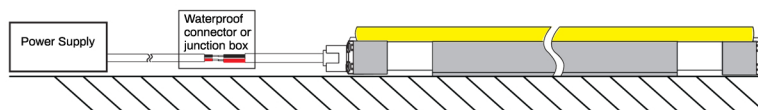

INSTALL

Attention

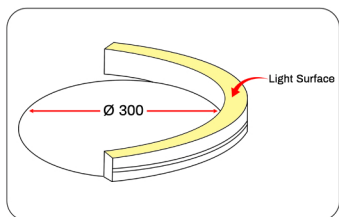

1. Correct bending way

Intallation

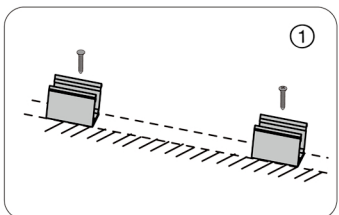

1. Installation of clip

Fix the clips and aluminum profile via the screws

⚠ Suggestion: 2pcs clips per meter.

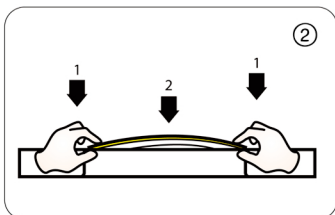

2. Installation of Neon

Simultaneously install the neon from both ends

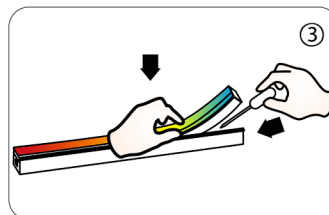

3. Installation of Neon

Should use tools to assist when remove the neon

Cutting/Soldering/Intall end cap

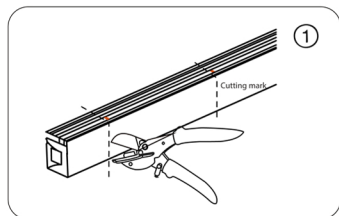

1. Cut the neon to be required length

⚠ The minimum cutting unit is based on the cutting mark.

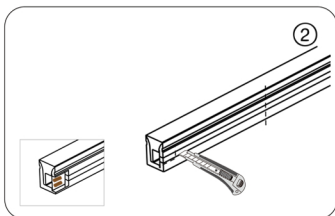

2. Cut the side of neon, expose the soldering pad

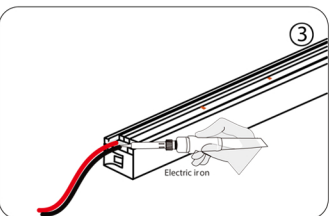

3. Solder the cable onto the PCB

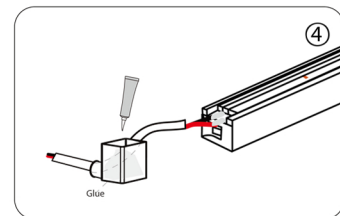

4. Put the wire into and inject glue into the end cap

⚠ The amount of glue is about 1/3-1/2 of end cap

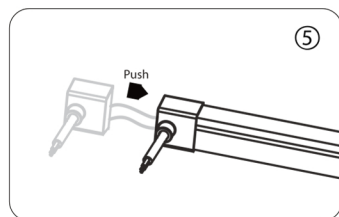

5. Push the end cap to wrap end of neon

⚠ After the glue is injected, the neon needs to be laid flat for 2 hours to before other process.

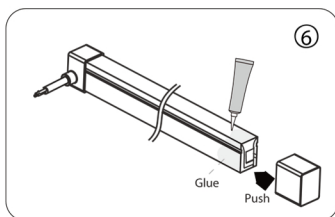

6. Apply gel around the tail of neon and install the end cap

⚠ After the glue is injected, the neon needs to be laid flat for 2 hours to before project process. Glue will complete dry after 24 hours.

