

## OVY

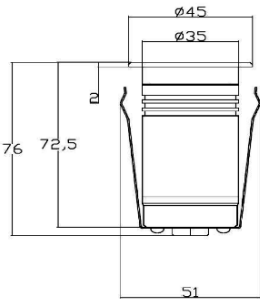

### Description:

OVY is an inground or ceiling recessed small wattage light typically feature durable, weather-resistant housings suitable for outdoor use. Excellent heat dissipation.

It include features such as corrosion resistance , dustproof, anodized and polished, sandblasted, not easy to rust and fade.

Stainless Steel Cover with Die cast aluminum body.

It comes with different CCT LED sources and Honeycomb optionally, this family is a perfect solution to the requirement.

It has very wide application like For landscape lighting, garden lighting, horticultural engineering design, public fountain square Lighting.

### Product Specifications:

Front cover : Stainless Steel 316  
 Housing : Die cast aluminum  
 Coating: Powder Coating  
 Glass : Tempered glass  
 Gasket: Moulding shaped silicone seal  
 Lens/Reflector : Optical lens (efficiency>90%)  
 Power Cable: 0.5 mt. power cable included  
 Driver : High efficiency, low flicker driver  
 Installation Type: Inground / Ceiling Recessed  
 Adjustable: No

### Technical Specifications:

Wattage:2- 3W  
 Voltage: 24VDC  
 Frequency: 50-60Hz  
 Light Source: OSRAM/EPISTAR/CREE  
 Lumen: 75lm/W  
 Mac Adam: 3 Step  
 Safety Class: II  
 Working Temperature:-20°C to 55°C  
 Life Time: 50,000hrs (L80/B10) at 35°C  
 Warranty: 5 Years

### Parameter:

|              |  |
|--------------|--|
| Wattage(W)   | : 2W                                     |
| Finish       | : Stainless Steel 316 (SS)               |
| Kelvin*      | : 2700K/ 3000K / 4000K / 6000K           |
| Beam Angle   | : 12° / 25° / 35° / 45° / 55° / Diffused |
| CRI          | : 80+                                    |
| Control Mode | : ON/OFF / DALI / 0 / 1-10V              |

Text Here...

### Order Code:

| Product Code | Wattage | CCT      | Voltage   | Beam Angle | Finish                 | Control Mode |
|--------------|---------|----------|-----------|------------|------------------------|--------------|
| 539044       | 02-2W   | 27-2700K | D - 24VDC | 12-12°     | SS-Stainless Steel 316 | 1-ON/OFF     |
|              |         | 30-3000K |           | 25-25°     |                        | 2-DALI       |
|              |         | 40-4000K |           | 35-35°     |                        | 3-0/1-10V    |
|              |         | 60-6000K |           | 45-45°     |                        |              |
|              |         |          |           | 55-55°     |                        |              |
|              |         |          |           | D-Diffused |                        |              |

**Ex: Order Code: 5390440227D'12SS1**

### Photometric :

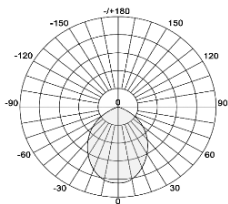

### Standard :

- EN 60598-1
- EN 60598-2-2
- EN 60598-3-2
- EN 60598-3-3

Pluxb luminaires are developed with globally recognized and tested components suppliers, however as per international standards tolerance in initial flux and connected load is at ±5%. Unless stated otherwise, the values apply to an ambient temperature of 25°C