

Installation instruction

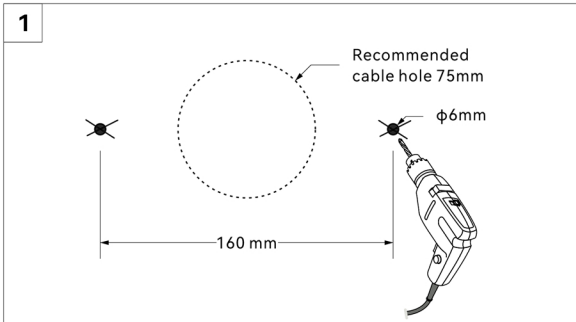

Dimensions of mounting holes

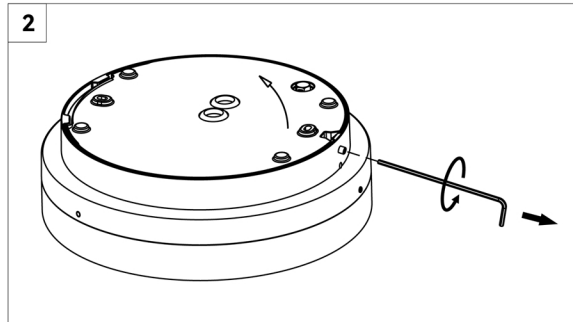

Unscrew and remove the back plate from the lamp body

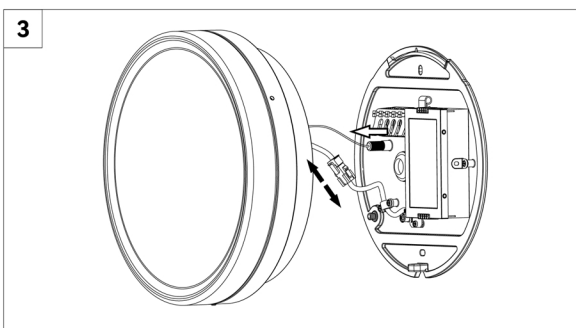

Disconnect the wires and safety steel rope

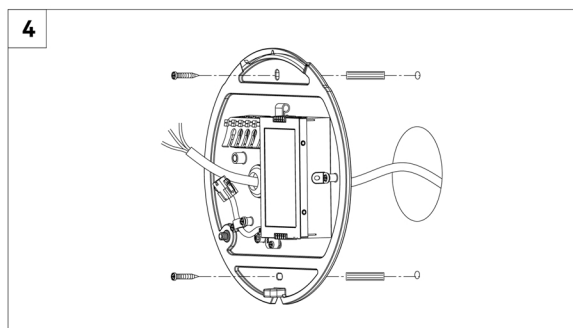

Put AC cable through the hole, and fix the backplate to the wall by 2 screws

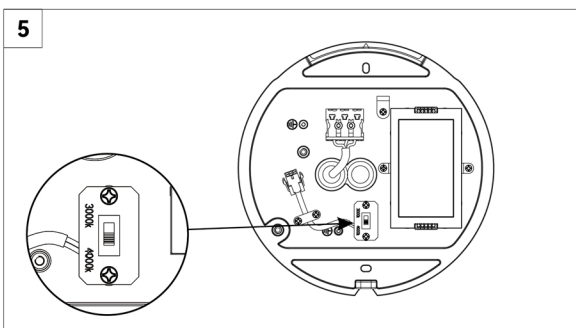

Insert the AC cable to the terminal blocks, and switch the CCT to the request position

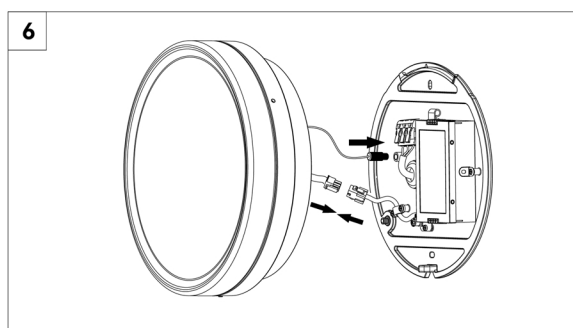

Connect the safety steel rope and wires.

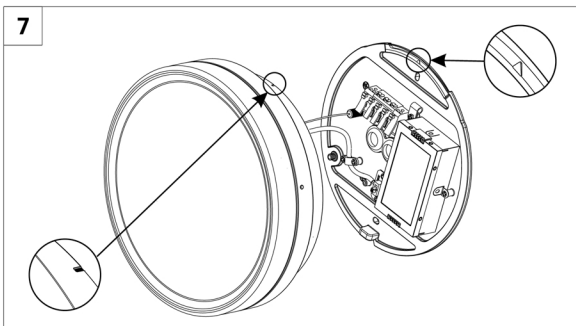

Insert the lamp body into the backplate, please make sure the small notch is aligned with the Arrow mark from backplate.

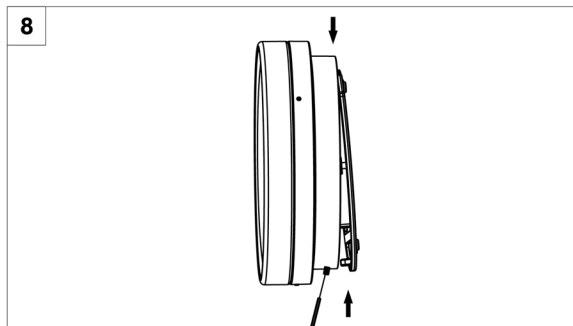

Screw it and make sure the lamp body is fixed tightly to the backplate.

Pluxb luminaires are developed with globally recognized and tested components suppliers, however as per international standards tolerance in initial flux and connected load is at $\pm 5\%$. Unless stated otherwise, the values apply to an ambient temperature of 25°C