

LUCA



Features:

LUCA is a canopy light is designed with world-class, approbated quality components including high-performance LEDs and drivers, ensuring long-term reliability and efficiency. It features a tempered glass cover that is not only durable but also easy to clean, maintaining clarity and performance over time.

Constructed with a compact die-cast body, the luminaire offers a solid mechanism and dependable quality. With ATEX certification, it provides safe operation in flammable and explosive environments, making it ideal for demanding applications.

Flexible installation options are available with accessories for recessed, surface, and bracket mounting to suit various requirements. Backed by a 5-year warranty, the canopy light ensures durability, safety,

Technical Specifications:

Input Voltage: AC100V-277V,50-60Hz
 Wattage: 80 - 155W
 Housing : Die cast aluminum
 Glass : Tempered Glass
 High Lumen: 165lm/w
 5 Step Mac Adam
 Safety Class : II
 Lamp Type: Lumiled
 Operating Temperature: -25°C to 50C
 Warranty: 5 Years
 Life Time: 100,000hrs at 25°C
 (L70/B10)

Fields of Application:

Airport
 Stadium
 Parking Lot
 Petrol Stations
 Warehouses
 Building Entrances
 Transport Hubs

Installation Method:

Bracket / Surface Mounted / Ceiling Recessed

Wattage(W)	:	80	100	120	155		
Finish	:	White (W)					
Kelvin*	:	1800K	2700K	3000K	4000K	5700K	6500K
Beam Angle	:	60°	90°	110°			
CRI	:	70+	80+				
Driver	:	ON/OFF	0/1-10V	DALI			

*Special Color and Finish on request

Product Code (558450240):

Wattage	Lumens(lm)	Dimension(LxWxH) mm
80	13,200LM	430x400x179
100	16,500LM	430x400x179
120	19,800LM	430x400x179
155	25,575LM	430x400x179

*Luminous flux value is calculated for 4000K CRI>80

Photometric:

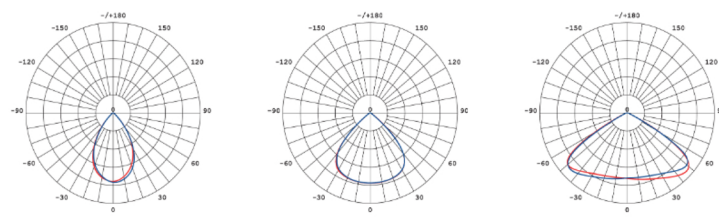

Standards

EN 60598-1

EN 60598-2-2

EN 60598-2-22

EN 60598-3-2

EN 60598-3-3

Order Code Ex: 558450240 18K 60D 7 1 W

CCT	Beam Angle	CRI	Driver	Finish
18K - 1800K	60D - 60°	7->70	1 - ON/OFF	W-White
27K - 2700K	90D - 90°	8->80	2 - 0/1-10V	
30K - 3000K	110D - 110°		3 - DALI	
40K - 4000K				
57K - 5700K				
65K - 6500K				

Surface Mounting

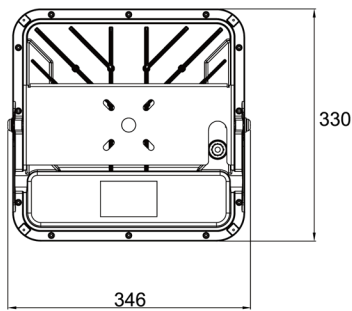

Recessed Mounting

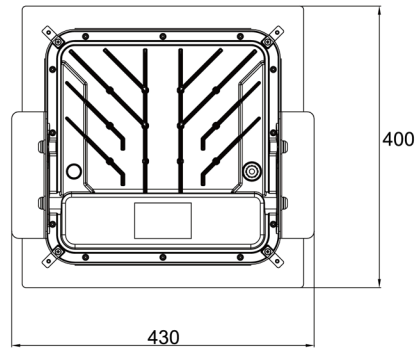

Bracket Mounting

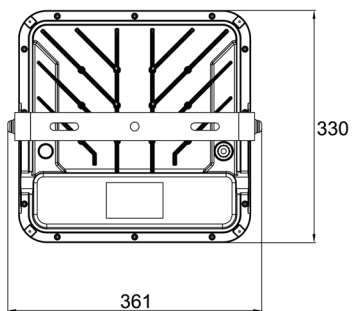
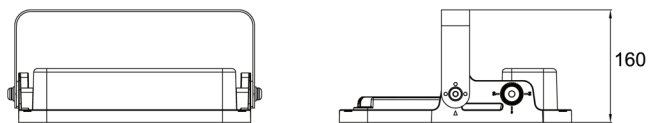

Pluxb luminaires are developed with globally recognized and tested components suppliers, however as per international standards tolerance in initial flux and connected load is at $\pm 5\%$. Unless stated otherwise, the values apply to an ambient temperature of 25°C

Installation Manual

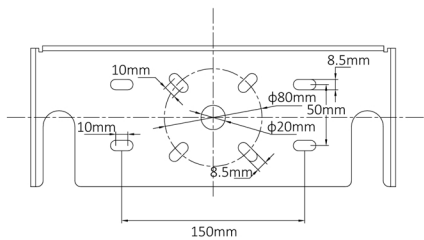

Surface Mounting

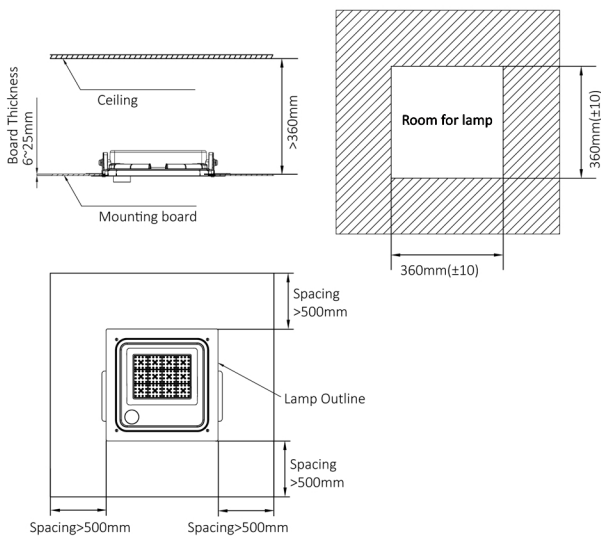

Recessed Mounting

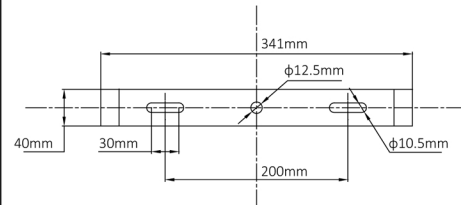

Bracket Mounting

Optional Accessories

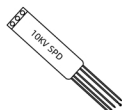

Extra 10KV SPD

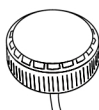

Motion Sensor

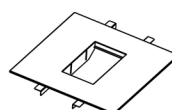

Customized frame

Pluxb luminaires are developed with globally recognized and tested components suppliers, however as per international standards tolerance in initial flux and connected load is at $\pm 5\%$. Unless stated otherwise, the values apply to an ambient temperature of 25°C