

KOUL

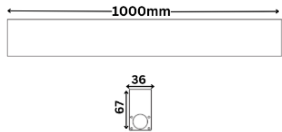
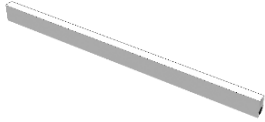

Description:

KOUL is a Linear inground outdoor lighting fixtures designed to be installed flush with the ground surface, providing subtle and aesthetically pleasing illumination.

It features a die-cast aluminum housing with a polyester spraying treatment on the surface. The light is equipped with imported anti-aging rubber seal-rings, ensuring reliable waterproofing.

Toughened glass cover, with high hardness, not easy to break.

The adjustable die-casting aluminum alloy bracket enables precise angling for easy and secure installation. The absence of infrared or UV radiation helps protect illuminated objects from heat damage and fading. Toughened safety glass for drive over applications up to 2000KG static load. It comes with different CCT and C5 Marine Grade Coating, this family is a perfect solution to the requirement.

The length can be customized 250mm, 500mm, 750mm, 1.5mtr. They are commonly used for accentuating architectural features, guiding pathways, or creating ambiance in outdoor spaces.

Product Specifications:

Housing : Die cast Aluminum
Glass : Tempered glass
Gasket: Molding shaped silicone seal
Accessory: Honey Comb
Lens/Reflector : Optical lens (efficiency>90%)
Power Cable: 0.5 mt. power cable included
Driver : High efficiency, low flicker driver
Installation Type: Inground

Technical Specifications:

Wattage: 20W
Voltage: DC24V
Frequency: 50-60Hz
Light Source: OSRAM/EPISTAR/CREE
Lumen: 120lm/W
Mac Adam: 3 Step
Safety Class: III
Working Temperature:-25°C to 60°C
Life Time: 50,000hrs (L80/B10) at 35°C
Humidity : <95%
Warranty: 5 Years

Parameter:

Wattage(W)	:	20W
Finish	:	Grey (G) / White (W)
Kelvin*	:	2700K/ 3000K/ 4000K / 6500K
Beam Angle	:	120°
CRI	:	80+
Control Mode	:	ON/OFF / DALI / 0 / 1-10V / Phase Cut

Order Code:

Product Code	Wattage	CCT	Voltage	Beam Angle	Finish	Control Mode
5493667	20 - 20W	27-2700K 30-3000K 40-4000K 65-6500K	D-24VDC	120-120°	G - Grey W - White	1-ON/OFF 2-DALI 3-0/1-10V 4-Phase Cut
54936672027D'120G						

Photometric:

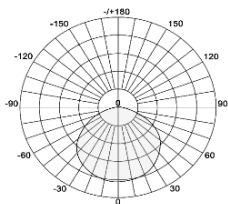

Standards :

- EN 60598-1
- EN 60598-2-2
- EN 60598-3-2
- EN 60598-3-3

Pluxb luminaires are developed with globally recognized and tested components suppliers, however as per international standards tolerance in initial flux and connected load is at $\pm 5\%$. Unless stated otherwise, the values apply to an ambient temperature of 25°C

Pluxb luminaires are developed with globally recognized and tested components suppliers, however as per international standards tolerance in initial flux and connected load is at $\pm 5\%$. Unless stated otherwise, the values apply to an ambient temperature of 25°C