

IRIS

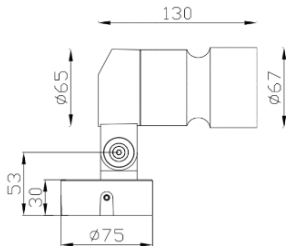

Description:

IRIS is a adjustable outdoor floodlight / spike light for accent and general illumination with low power LED light sources, excellent heat dissipation.

It comes with different CCT and RGB LED sources and various beam angles this family is a perfect solution to the requirement.

The zoomable capability enables users to adjust the width of the beam to suit different lighting needs, offering flexibility and customization in outdoor lighting design.

It has very wide application like trees, sign terraced landscape, urban lighting, internal and external walls of buildings, etc.

Product Specifications:

Housing : Die cast aluminum
Front cover : Die cast aluminum
Coating: Powder Coating
Glass : Silver print
Gasket: Molding shaped silicone seal
Lens/Reflector : Optical lens (efficiency>90%)
Power Cable: 0.5 mt. power cable included
Driver : High efficiency, low flicker driver
Installation Type: Surface Mounted
Adjustable: Yes

Technical Specifications:

Wattage: 3-9W
Voltage: DC24V / 220-240V AC
Frequency: 50-60Hz
Light Source: OSRAM/EPISTAR/CREE
Lumen: 80lm/W
Mac Adam: 3 Step
Safety Class: III / II
Working Temperature:-20°C to 55°C
Life Time: 50,000hrs (L80/B10) at 35°C
Warranty: 5 Years

Parameter:

Wattage(W)	:	3W / 6W / 9W
Finish	:	Grey (G) / Customized (C)
Kelvin*	:	2700K / 3000K / 4000K / 6000K / RGB / RGBW
Beam Angle	:	8° / 15° / 25° / 40° / 60°
CRI	:	80
Control Mode	:	ON/OFF / DALI / 0 / 1-10V / Phase Cut / DMX

Order Code:

Product Code	Wattage	CCT	Voltage(DC)	Beam Angle	Finish	Control Mode
541067	03C-3W	27-2700K	D-24VDC	8 - 8°	G-Grey	1-ON/OFF
	06C-6W	30-3000K		15 - 15°	C-Customized	2-DALI
	09C-9W	40-4000K		25 - 25°		3-0/1-10V
	09-9W(3x3W)	60-6000K		40 - 40°		4-Phase cut
		92-RGB		60 - 60°		5-DMX
		93-RGB DMX				
		82-RGBW				
		83-RGBW DMX				

Ex: Order Code: 54106703C27D'8G1

Photometric :

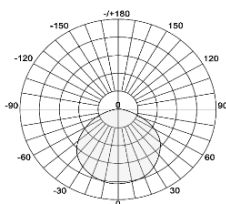

Standards :

EN 60598-1
EN 60598-2-2
EN 60598-3-2
EN 60598-3-3

Pluxb luminaires are developed with globally recognized and tested components suppliers, however as per international standards tolerance in initial flux and connected load is at $\pm 5\%$. Unless stated otherwise, the values apply to an ambient temperature of 25°C

Product Code	Wattage	CCT	Voltage(AC)	Beam Angle	Finish	Control Mode
541067	06C-6W	27-2700K	A-220-240VAC	8 - 8°	G-Grey	1-ON/OFF
	09C-9W	30-3000K		15 - 15°	C-Customized	2-DALI
		40-4000K		25 - 25°		3-0/1-10V
		60-6000K		40 - 40°		4-Phase cut
				60 - 60°		5-DMX
Ex: Order Code: 54106706C27A'8G1						

Pluxb luminaires are developed with globally recognized and tested components suppliers, however as per international standards tolerance in initial flux and connected load is at ±5%. Unless stated otherwise, the values apply to an ambient temperature of 25°C