

FLORA WHITE



DESCRIPTION:

FLORA WHITE Flexible Wall Washer Series Designed for unconventional spaces goes beyond aesthetics. Featuring a UV-resistant PC lens and an IP67-rated housing, it is built for durable outdoor applications. Dynamic lighting effects can be precisely controlled allowing for varied color programs. Its flexible structure breaks through space limitations, with a minimum bending radius of just 20 cm, making it ideal for curved surfaces and unique architectural designs. Control mode : ON/OFF, DALI, Phase Cut, 0/1-10V.

TECHNICAL DETAILS:

Power : 36W/M
Voltage : DC24V
CRI >90
Length/Reel : 5M
Cutting length : 50mm
Led Qty : 20LEDs/M
Working Temperature : -40°~55°C
Storage Temperature : -40°~85°C
Voltage Range : 23 ~25V dc
Reverse Voltage : 25V dc
Warranty : 5 years

LUMENS :

CCT	20°	30°	40°	30x40°
2700K	3096lm	2736lm	2376lm	1980lm
3000K	3240lm	2880lm	2520lm	2160lm
4000K	3420lm	3060lm	2700lm	2304lm
5000K	3492lm	3132lm	2772lm	2376lm
5700K	3600lm	3240lm	2880lm	2520lm
6500K	3780lm	3420lm	3060lm	2736lm

INSTALLATION :

Surface Mounted

Product Code : 7003021

DIMENSION:

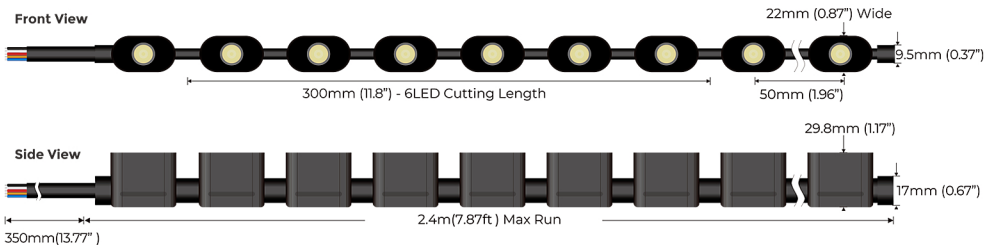

LIGHT DISTRIBUTION:

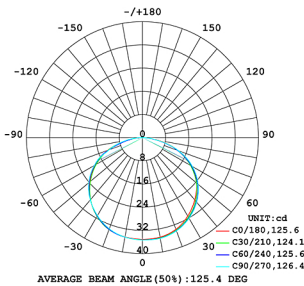

BENDING:



End cap

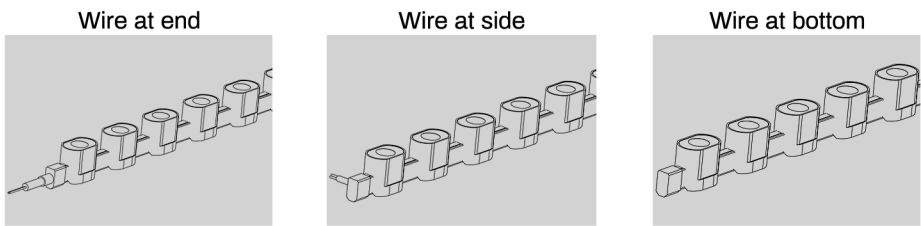

Standards

- EN 60598-1
- EN 60598-2-2
- EN 60598-3-2

Order Code Ex : 7003021	36	27-65	20
Product Code	Power	CCT	Beam Angle
7003021	36-36W	27-2700K	20-20°
		30-3000K	30-30°
		40-4000K	40-40°
		50-5000K	30x40°
		57-5700K	
		65-6500K	

Pluxb luminaires are developed with globally recognized and tested components suppliers, however as per international standards tolerance in initial flux and connected load is at ±5%. Unless stated otherwise, the values apply to an ambient temperature of 25°C

ACCESSORIES

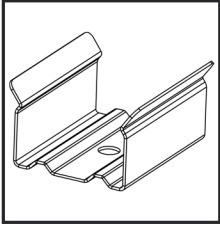

Mounting Clips
Order Code : 7033021-01
Dimension : W24.26mmxH14.44mm
Material : stainless steel
Color : silver
Each meter led strips needs
2 clips + 2 screws



IP67 Signal Connector
Order Code : 7033021-05
Wire Gauge : 0.326mm²/22AWG
Protection : IP67 (Mated)

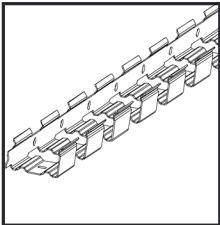

Rotating bracket
Order Code : 7033021-02
Dimension : W24.26mmxH14.44mm
Material : stainless steel
Color : silver



IP67 T Type Connector
Order Code : 7033021-06
Wire Gauge : 0.326mm²/22AWG
Protection : IP67 (Mated)



IP67 Connector 3PIN
Order Code: 7033021-03
Wire gauge: 0.326mm²/22AWG
Protection: IP67 (Mated)



IP67 Signal Connector
Order Code : 7033021-07
Wire Gauge : 0.326mm²/22AWG
Protection : IP67 (Mated)



IP67 Connector 3PIN
Order Code: 7033021-04
Wire gauge: 0.326mm²/22AWG
Protection: IP67 (Mated)

ADDITIONAL INFO.

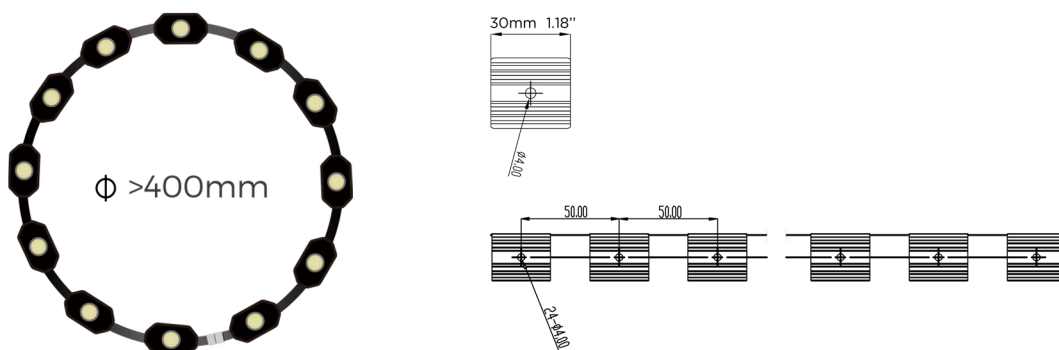

- ▶ Please light it up for a quick check before installation.
- ▶ Bending diameter FLORA TUNABLE Flexible wall washer 3021 of is 400mm for Surface Mounted Do not bend too sharp or twist. If bend it wrongly.

During installation, please make sure there are at least two workers to cooperate together and strictly follow the instruction manuals.

▶

Warranty: All LED light are warranted to be free from defects in product itself for 5 years from the date of purchase. This warranty

- ▶ does not cover failures due to abuse, misuse, improper handling, act of nature, negligence, normal wear, accidental damage, repairs made by the purchaser or incorrect voltage conditions.

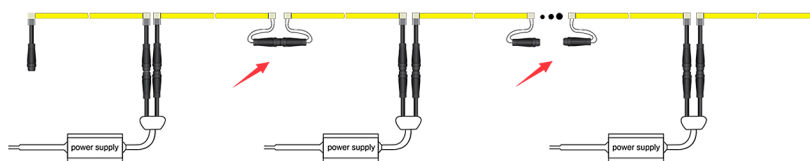

Note:

-36W/M Max. 5mtr run length to Single side feed.

-The given data are typical values due to the tolerances of the production process and the electrical components, values for light output and electrical power can vary up to 5%.

ASYMMETRIC DIAGRAM

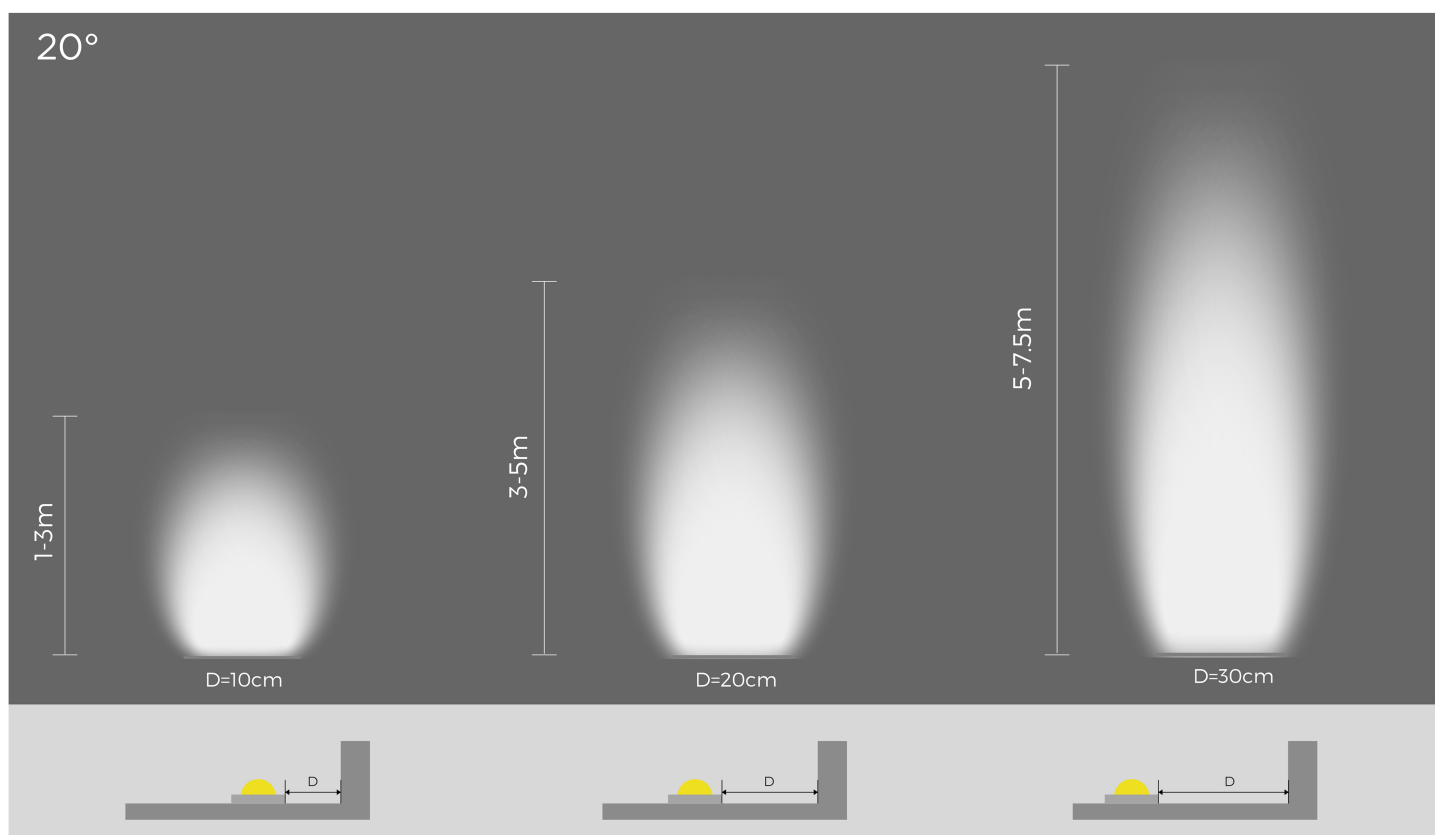

WIRING DIAGRAM

DMX

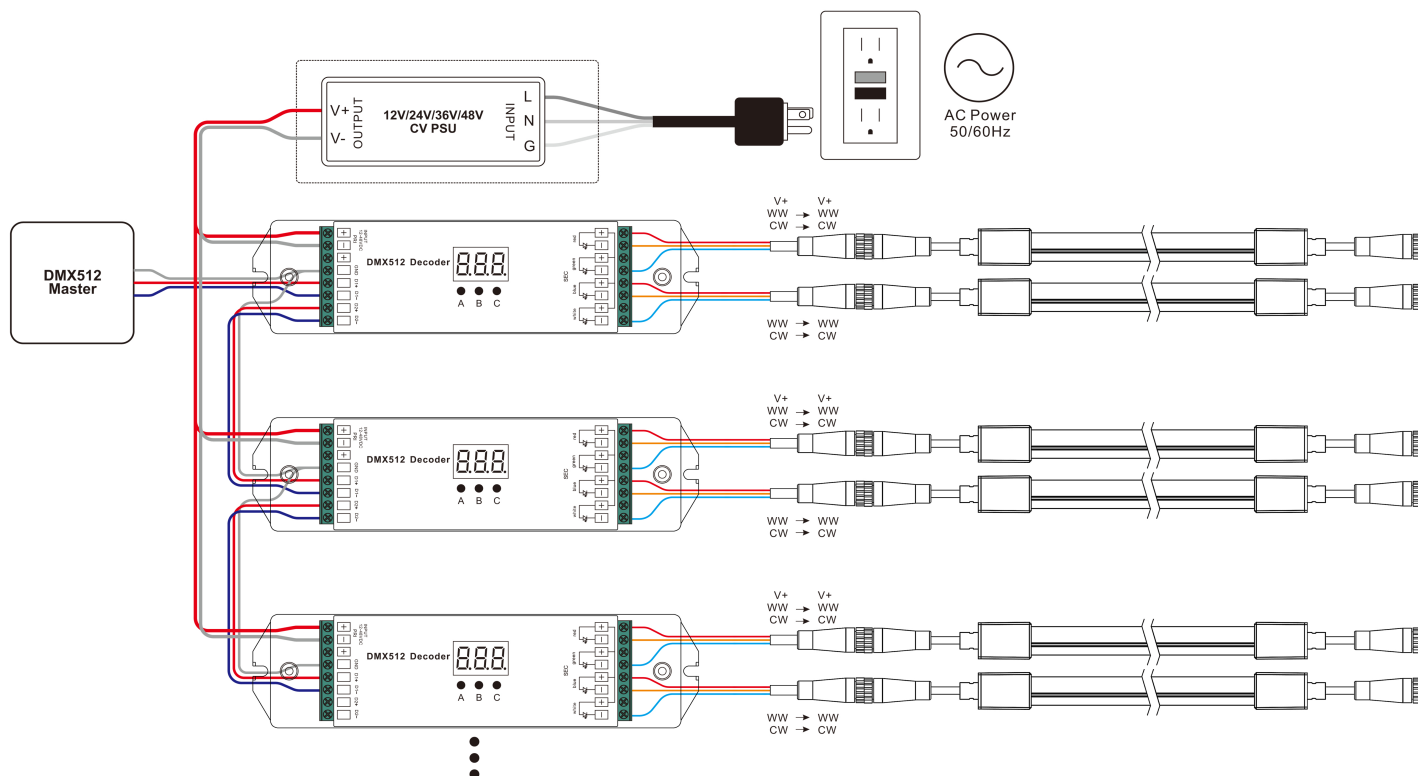

1 DALI

