

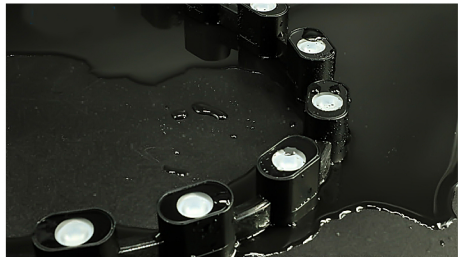

# FLORA RGB



## DESCRIPTION:

FLORA RGB Flexible Wall Washer Series Designed for unconventional spaces goes beyond aesthetics. Featuring a UV-resistant PC lens and an IP67-rated housing, it is built for durable outdoor applications. Dynamic lighting effects can be precisely controlled allowing for varied color programs. Its flexible structure breaks through space limitations, with a minimum bending radius of just 20 cm, making it ideal for curved surfaces and unique architectural designs. Control mode : DALI / DMX.

## TECHNICAL DETAILS:

Power : 36W/M  
Voltage : DC24V  
CRI >90  
Length/Reel : 5M  
Cutting length : 300mm  
Led Qty : 20LEDs/M  
Working Temperature : -40°~55°C  
Storage Temperature : -40°~85°C  
Voltage Range : 23 ~25V dc  
Reverse Voltage : 25V dc  
Warranty : 5 years

## LUMENS :

### CCT : RGB | OPTICS

290lm/W | 20°  
270lm/W | 30°  
240lm/W | 40°  
230lm/W | 30°x40°

## INSTALLATION : Surface Mounted

Product Code : 7013021

## DIMENSION:

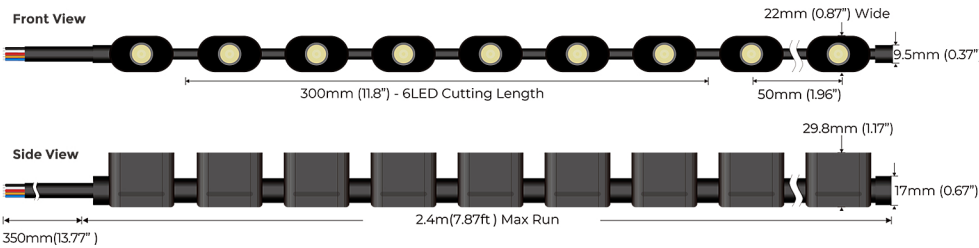

## LIGHT DISTRIBUTION:

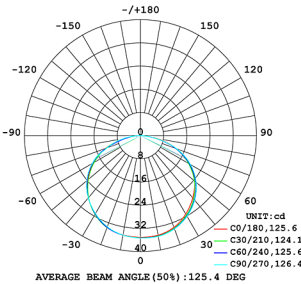

## BENDING:



## End cap

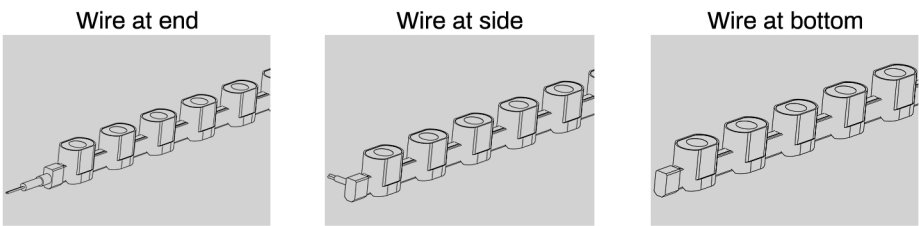

## Standards

EN 60598-1  
EN 60598-2-2  
EN 60598-3-2

Order Code Ex : 7013021	36	92	20
Product Code	Power	CCT	Beam Angle
7013021	36-36W	92-RGB	20-20°
			30-30°
			40-40°
			30x40°

Pluxb luminaires are developed with globally recognized and tested components suppliers, however as per international standards tolerance in initial flux and connected load is at ±5%. Unless stated otherwise, the values apply to an ambient temperature of 25°C

## ACCESSORIES

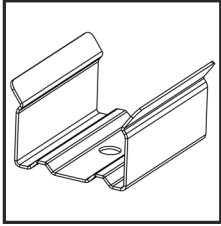

Mounting Clips  
Order Code : 7013021-01  
Dimension : W24.26mmxH14.44mm  
Material : stainless steel  
Color : silver  
Each meter led strips needs  
2 clips + 2 screws



IP67 Signal Connector  
Order Code : 7013021-05  
Wire Gauge : 0.326mm<sup>2</sup>/22AWG  
Protection : IP67 (Mated)

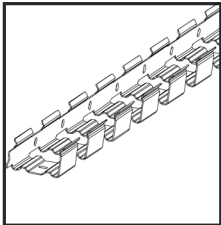

Rotating bracket  
Order Code : 7013021-02  
Dimension : W24.26mmxH14.44mm  
Material : stainless steel  
Color : silver



IP67 T Type Connector  
Order Code : 7013021-06  
Wire Gauge : 0.326mm<sup>2</sup>/22AWG  
Protection : IP67 (Mated)



IP67 Connector 4PIN  
Order Code: 7013021-03  
Wire gauge: 0.326mm<sup>2</sup>/22AWG  
Protection: IP67 (Mated)  
Connector type : Male



IP67 Signal Connector  
Order Code : 7013021-07  
Wire Gauge : 0.326mm<sup>2</sup>/22AWG  
Protection : IP67 (Mated)



IP67 Connector 4PIN  
Order Code: 7013021-04  
Wire gauge: 0.326mm<sup>2</sup>/22AWG  
Protection: IP67 (Mated)  
Connector type : Female

## ADDITIONAL INFO.

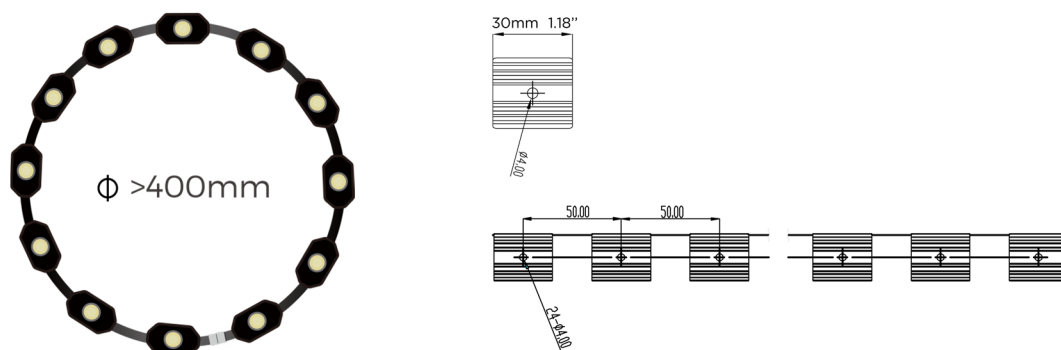

- ▶ Please light it up for a quick check before installation.
- ▶ Bending diameter of FLORA RGB 3021 is 150mm for Horizontal. Do not bend too sharp or twist. If bend it wrongly, PCB inside will be damaged and the lighting fixture will not turn on.
- ▶ During installation, please make sure there are at least two workers to cooperate together and strictly follow the instruction manuals.
- ▶ Warranty: All LED light are warranted to be free from defects in product itself for 5 years from the date of purchase. This warranty does not cover failures due to abuse, misuse, improper handling, act of nature, negligence, normal wear, accidental damage, repairs made by the purchaser or incorrect voltage conditions.

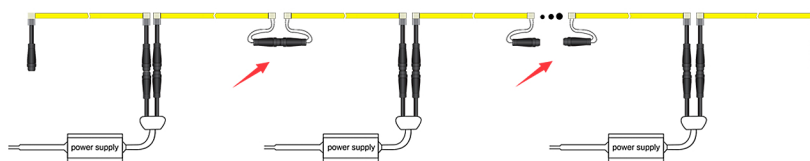

### Note:

-36W/M Max. 5mtr run length to Single side feed.

-The given data are typical values due to the tolerances of the production process and the electrical components, values for light output and electrical power can vary up to 5%.

## ASYMMETRIC DIAGRAM

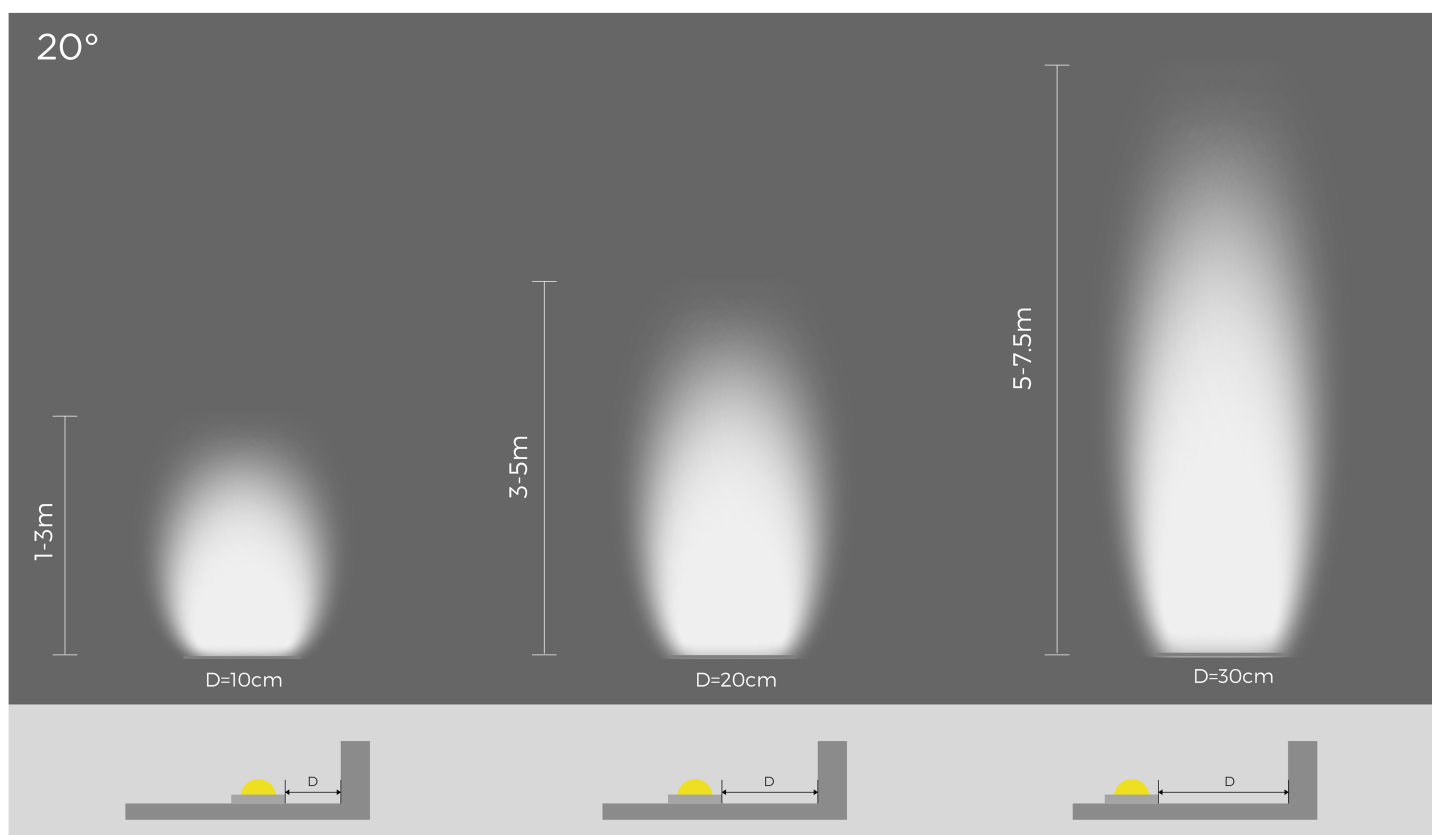



# WIRING DIAGRAM

## DMX

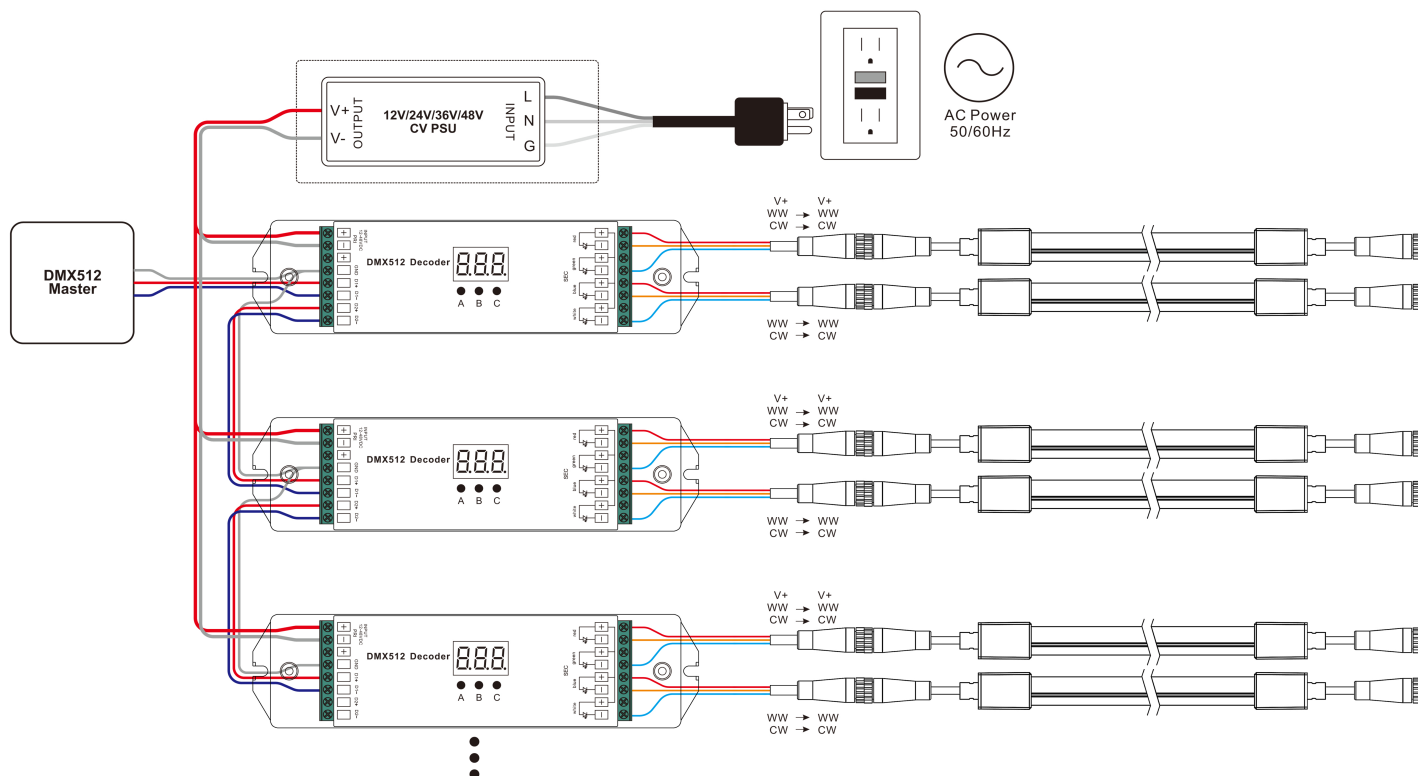

## 1 DALI

