

FLORA RGB DMX



DESCRIPTION:

FLORA RGB DMX512 Flexible Wall Washer Series Designed for unconventional spaces goes beyond aesthetics. Featuring a UV-resistant PC lens and an IP67-rated housing, it is built for durable outdoor applications. Dynamic lighting effects can be precisely controlled allowing for varied color programs. Its flexible structure breaks through space limitations, with a minimum bending radius of just 20 cm, making it ideal for curved surfaces and unique architectural designs. Control mode : DMX512.

TECHNICAL DETAILS:

Power : 36W/M
Voltage : DC24V
CRI >90
IC Chips : SM18522PS
Length/Reel : 5M
Cutting length : 300mm
Led Qty : 20LEDs/M
Pixels : 4 pixels/M
Working Temperature : -40°~55°C
Storage Temperature : -40°~85°C
Voltage Range : 23 ~25V dc
Reverse Voltage : 25V dc
Warranty : 5 years

LUMENS :

CCT : RGB | OPTICS

290lm/W	20°
270lm/W	30°
240lm/W	40°
230lm/W	30°x40°

INSTALLATION : Surface Mounted

Product Code : 7053021

DIMENSION:

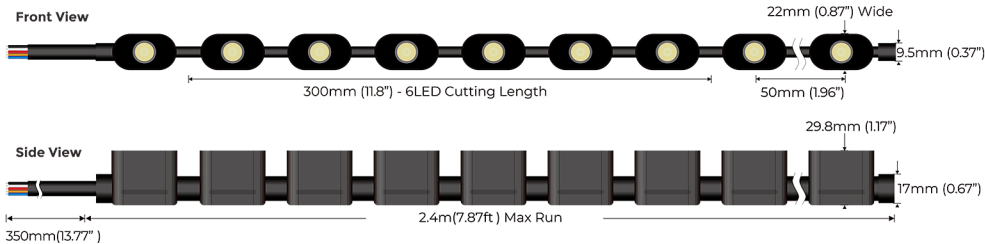

LIGHT DISTRIBUTION:

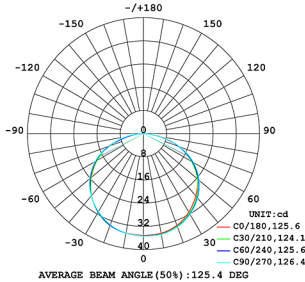

BENDING:



End cap

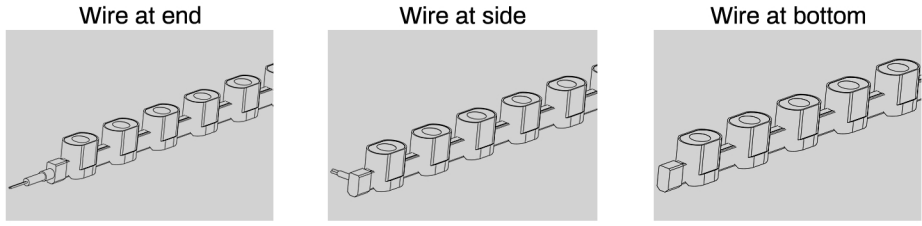

Standards

- EN 60598-1
- EN 60598-2-2
- EN 60598-3-2

Order Code Ex : 7053021	36	92	20
Product Code	Power	CCT	Beam Angle
7053021	36-36W	92-RGB	20-20°
			30-30°
			40-40°
			30x40°

Pluxb luminaires are developed with globally recognized and tested components suppliers, however as per international standards tolerance in initial flux and connected load is at ±5%. Unless stated otherwise, the values apply to an ambient temperature of 25°C

ACCESSORIES

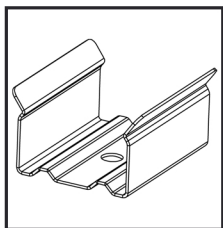

Mounting Clips
Order Code : 7053021-01
Dimension : W24.26mmxH14.44mm
Material : stainless steel
Color : silver
Each meter led strips needs
2 clips + 2 screws



IP67 Signal Connector
Order Code : 7053021-05
Wire Gauge : 0.326mm²/22AWG
Protection : IP67 (Mated)

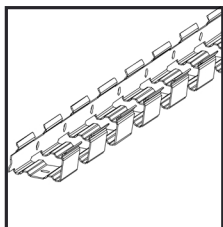

Rotating bracket
Order Code : 7053021-02
Dimension : W24.26mmxH14.44mm
Material : stainless steel
Color : silver



IP67 T Type Connector
Order Code : 7053021-06
Wire Gauge : 0.326mm²/22AWG
Protection : IP67 (Mated)



IP67 Connector 5PIN
Order Code: 7053021-03
Wire gauge: 0.326mm²/22AWG
Protection: IP67 (Mated)



IP67 Signal Connector
Order Code : 7053021-07
Wire Gauge : 0.326mm²/22AWG
Protection : IP67 (Mated)



IP67 Connector 5PIN
Order Code: 7053021-04
Wire gauge: 0.326mm²/22AWG
Protection: IP67 (Mated)

ADDITIONAL INFO.

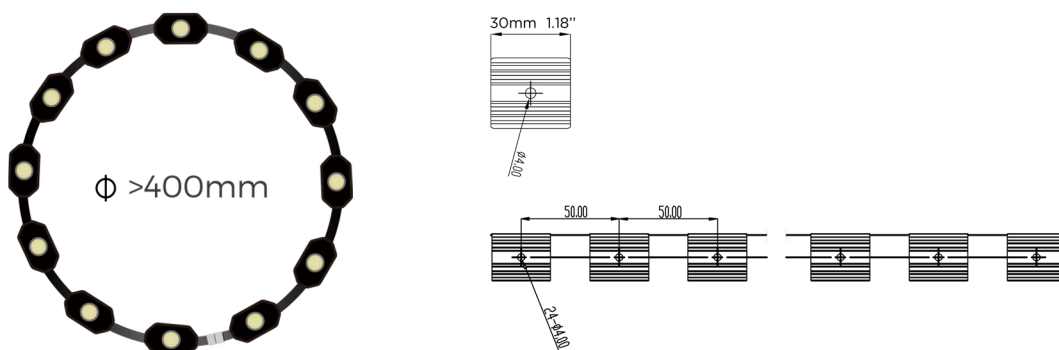

- ▶ Please light it up for a quick check before installation.
- ▶ Bending diameter of FLORA RGB DMX 3021 is 150mm for Horizontal. Do not bend too sharp or twist. If bend it wrongly, PCB inside will be damaged and the lighting fixture will not turn on.
- ▶ During installation, please make sure there are at least two workers to cooperate together and strictly follow the instruction manuals.
- ▶ Warranty: All LED light are warranted to be free from defects in product itself for 5 years from the date of purchase. This warranty does not cover failures due to abuse, misuse, improper handling, act of nature, negligence, normal wear, accidental damage, repairs made by the purchaser or incorrect voltage conditions.

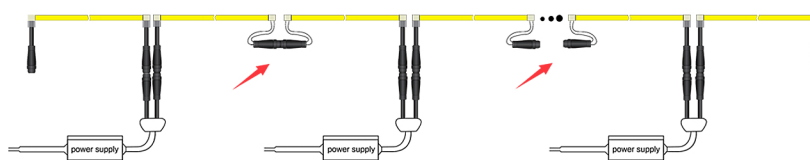

Note:

-36W/M Max. 5mtr run length to Single side feed.

-The given data are typical values due to the tolerances of the production process and the electrical components, values for light output and electrical power can vary up to 5%.

ASYMMETRIC DIAGRAM

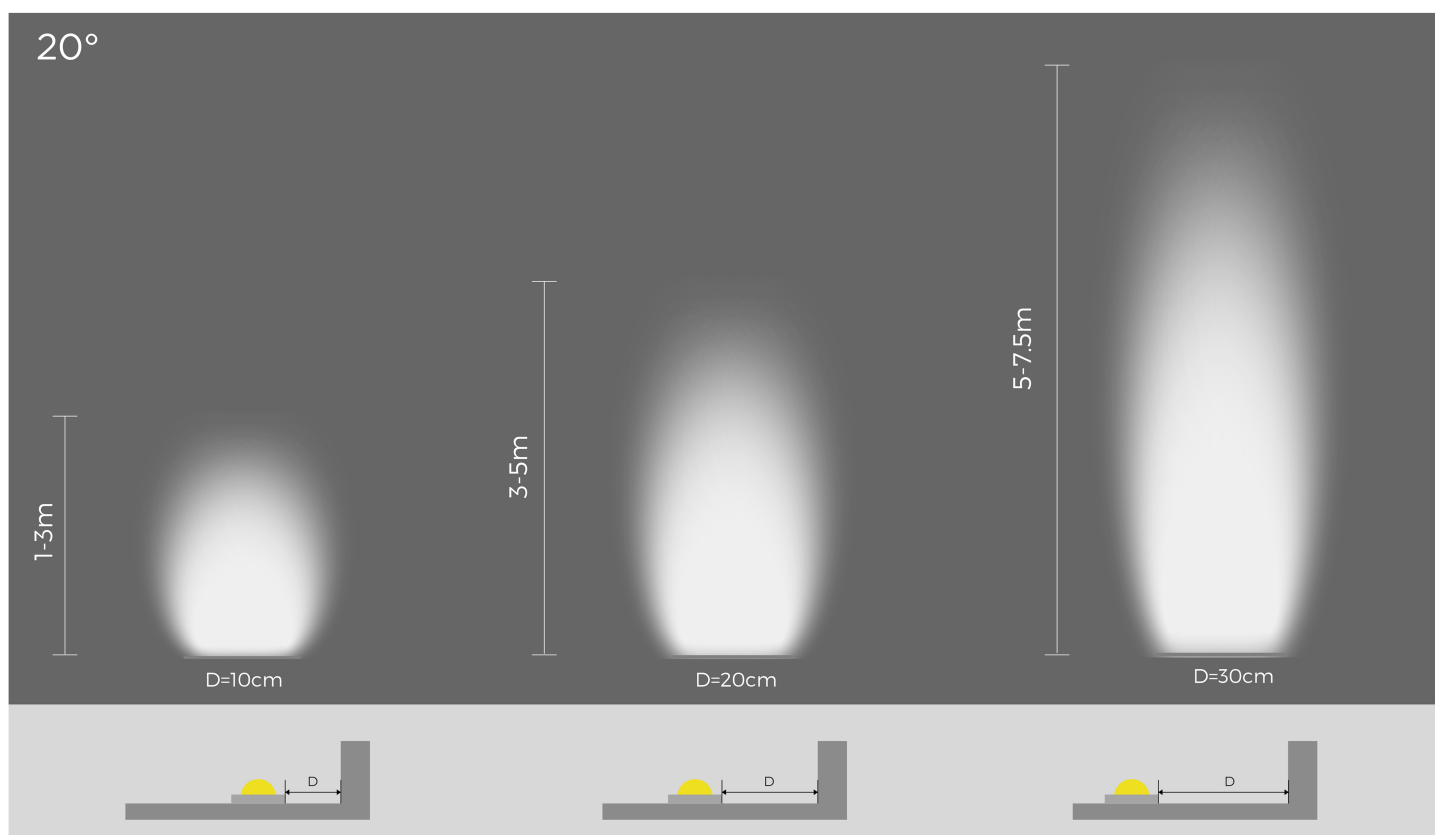

WIRING DIAGRAM

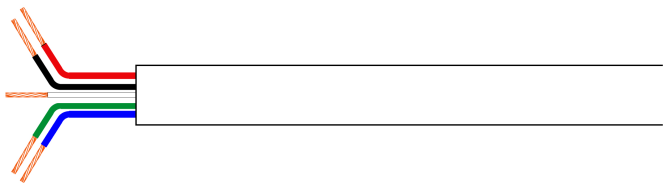
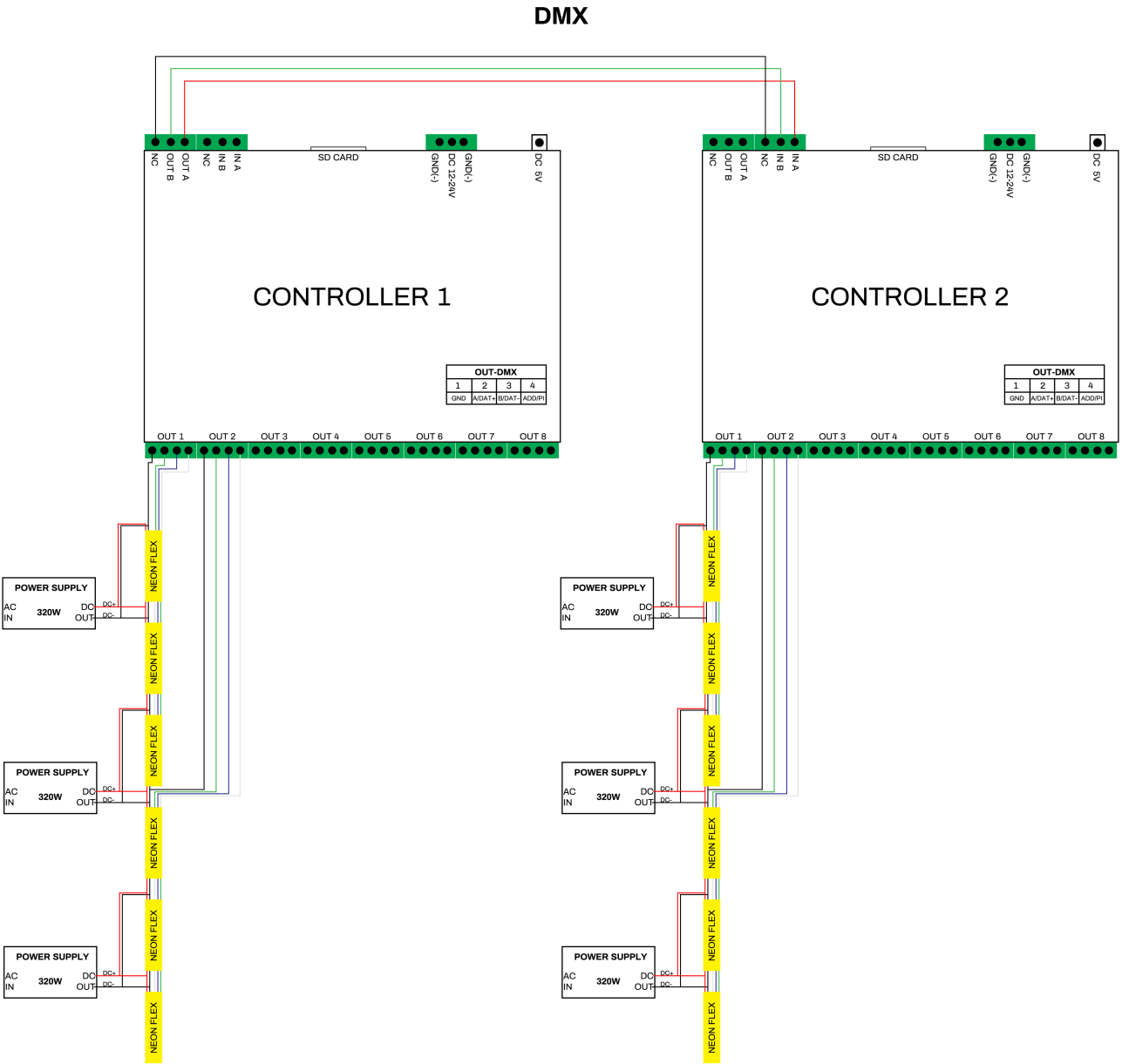

DMX PIXELS CHASING PRODUCT

Red---24V+

Black---24V-

Green---(PI)Address

White---(A)DMX+

Blue---(B)DMX-