

## DROP

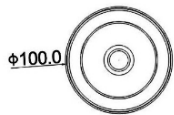
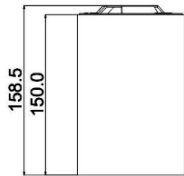

### Features:

DROP Anti-glare cylinder Type LED Light, extrusion aluminum body.  
High efficiency aluminum reflector to ensure that the light is more soft and comfortable.  
Die-casting aluminum body with lens and radiator with good heat dissipation.  
Easy to install and maintain.  
Fast and simple screw lock type Metal ceiling base easy to install and maintain  
High light Transmissivity.  
Homogenous, well-balanced light dispersing, no shadow.

### Technical Specifications:

Input Voltage: 220-240 V AC, 50 Hz.  
Wattage: 30-40 W  
High Lumen: 110lm/w  
3 STEP Mac Adam  
High efficiency, low flicker driver  
Lamp Type: COB  
Operating Temperature: -20°C to 45°C  
Glow Wire Test 850° C  
Warranty: 5 Years  
Life Time: 50,000hrs at 25°C (L80/B10)

### Fields of Application:

Retail  
Education  
Galleries hotels  
Living spaces  
Conference rooms  
Counters  
Restaurants

### Installation Method:

Surface Mounted / Suspended.

Wattage(W)	:	30	35	40	
Finish	:	White(W)	Black(B)	Silver (S)	
Kelvin*	:	2700K	3000K	4000K	5000K
Beam Angle	:	15°	24°	36°	
CRI	:	80+	90+		
Driver	:	ON/OFF	0/1-10V	DALI	Phase Dimming Bluetooth

\*Special Color & Finish on request

### Product Code (96810040):

Wattage	Lumens(lm)	Dimension(ØxH) mm
30	3300LM	100x150
35	3850LM	100x150
40	4400LM	100x150

\*Luminous flux value is calculated for 4000K CRI>80

### Photometric:

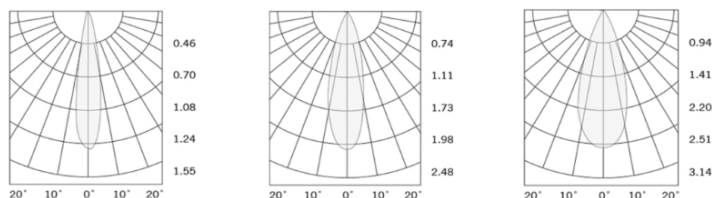

Pluxb luminaires are developed with globally recognized and tested components suppliers, however as per international standards tolerance in initial flux and connected load is at  $\pm 5\%$ . Unless stated otherwise, the values apply to an ambient temperature of 25°C

- Standards
- EN 60598-1
- EN 60598-2-2
- EN 60598-2-22
- EN 60598-3-2
- EN 60598-3-3

Order Code Ex: 96810040 27K 15D 8 1 W

CCT	Beam Angle	CRI	Driver	Finish
27K - 2700K	15D - 15°	8->80	1 - ON/OFF	W-White
30K - 3000K	24D - 24°	9->90	2 - 0/1-10V	B-Black
40K - 4000K	36D - 36°		3 - DALI	S-Silver
50K - 5000K			4 - Phase Dimming	
			5 - Bluetooth	

Pluxb luminaires are developed with globally recognized and tested components suppliers, however as per international standards tolerance in initial flux and connected load is at ±5%. Unless stated otherwise, the values apply to an ambient temperature of 25°C