

## BRUNO

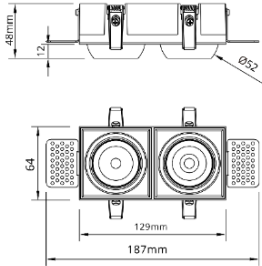

### Features:

BRUNO is a Trimless Downlight has a sleek and versatile recessed lighting. Crafted from durable die cast Aluminum this fixture ensures longevity, superior heat dissipation,

Its sleek design is engineered for precision and adaptability, featuring a 50° and 355° rotation, allowing for precise light direction.

Available in six sophisticated body colors—Black, White, Matt Silver, Matt Brass, Nickel, and Chrome.

### Technical Specifications:

Input Voltage: 220- 240 V AC, 50 Hz.

Wattage: 2x8W

High Lumen: 90lm/w

3 STEP Mac Adam

High efficiency, low flicker driver

Lamp Type: COB

Operating Temperature: -20°C to 45°C

Glow Wire Test 850° C

Warranty: 5 Years

Life Time: 50,000hrs at 25°C (L80/B10).

### Fields of Application:

- Retail
- Galleries hotels
- Living spaces
- Conference rooms
- Counters
- Restaurants

### Installation Method:

Recessed Adjustable

Wattage	:	2x8					
Finish	:	White(W)	Black(B)	Silver(S)	Brass(B)	Nickel(N)	Chrome(C)
Kelvin*	:	2700K	3000K	3500K	4000K	5000K	5700K
Beam Angle	:	18°	24°	36°	60°		
CRI	:	90+					
Driver	:	ON/OFF	0/1-10V	DALI	Phase Dimming		

\*Special Color & Finish on request

### Product Code (96818708.40):

Wattage	Lumens(lm)	Dimension(LxWxH)m	Cut Out (mm)
2x8	1440LM	187x64x48	135x65

\*Luminous øux value is calculated for 4000K CRI>80

### Photometric:

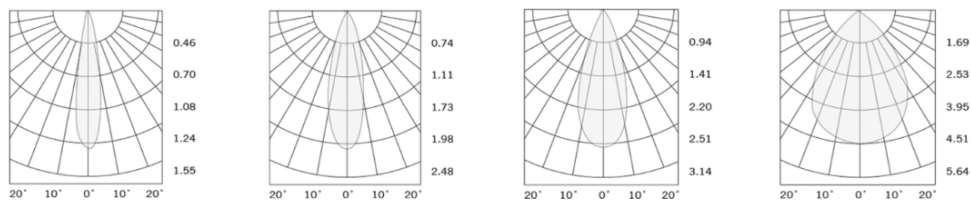

Pluxb luminaires are developed with globally recognized and tested components suppliers, however as per international standards tolerance in initial flux and connected load is at ±5%. Unless stated otherwise, the values apply to an ambient temperature of 25°C

## Standards

EN 60598-1

EN 60598-2-2

EN 60598-2-22

EN 60598-3-2

EN 60598-3-3

Order Code Ex: 96818708.40 27K 18D 9 1 W

CCT	Beam Angle	CRI	Driver	Finish
27K - 2700K	18D - 18°	9->90	1 - ON/OFF	W-White
30K - 3000K	24D - 24°		2 - 0/1-10V	B-Black
35K - 3500K	36D - 36°		3 - DALI	S-Silver
40K - 4000K	60D - 60°		4 - Phase Dimming	B-Brass
50K - 5000K				N-Nickel
57K - 5700K				C-Chrome

Pluxb luminaires are developed with globally recognized and tested components suppliers, however as per international standards tolerance in initial flux and connected load is at  $\pm 5\%$ . Unless stated otherwise, the values apply to an ambient temperature of 25°C