

ARIA

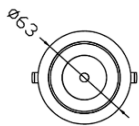
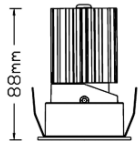

Features:

ARIA is Recessed Spot Light made from die-cast aluminum with a solvent-free powder coating for durability.

It features a compact lamp body with high-power output, making it suitable for both low and high ceiling suspension.

Additionally, the spotlight is available in various reflector color options, including Matt Black, Dark Chrome, Matt White, Matt Gold and Chrome.

A mini small cutout, allowing for a discreet installation, and it offers tiltability of 30° with one side for directional lighting.

The spotlight also supports different beam angles providing flexibility in light distribution.

Technical Specifications:

Input Voltage: 220- 240 V AC, 50/60Hz.

Wattage: 8-12W

High Lumen: 90lm/w

Light source: Citizen CLU02Q-1202

2 STEP Mac Adam

High efficiency, low flicker driver

Lamp Type: COB

Operating Temperature: -20°C to 45°C

Glow Wire Test 850° C

Warranty: 5 Years

Lifetime 50,000hrs at a 25°C(L90/B10)

Fields of Application:

- Retail
- Education
- Galleries hotels
- Living spaces
- Museums
- Restaurants
- Painting Exhibitions
- Theaters

Installation Method:

Recessed Adjustable

Wattage(W)	:	8	10	12		
Finish	:	White(W)	Black(B)			
Kelvin*	:	2700K	3000K	3500K	4000K	5700K
Beam Angle	:	18°	24°	36°	50°	
CRI	:	90+				
Driver	:	ON/OFF	DALI	Phase Dimming		

*Special Color and Finish on request

Product Code (96706312.50):

Wattage	Lumens(lm)	Dimension (ØxH) mm	Cut Out (mm)
8	720LM	63x88	55
10	900LM	63x88	55
12	1080LM	63x88	55

*Luminous lux value is calculated for 4000K CRI>90

Photometric:

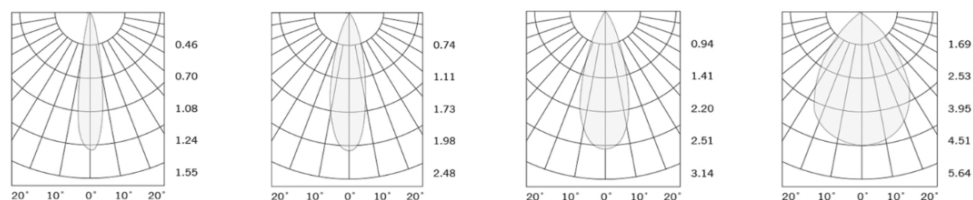

Pluxb luminaires are developed with globally recognized and tested components suppliers, however as per international standards tolerance in initial flux and connected load is at ±5%. Unless stated otherwise, the values apply to an ambient temperature of 25°C

Standards

EN 60598-1

EN 60598-2-2

EN 60598-2-22

EN 60598-3-2

EN 60598-3-3

Order Code Ex: 96706312.50 27K 18D 9 1 W

CCT	Beam Angle	CRI	Driver	Finish
27K - 2700K	18D - 18°	9-	1 - ON/OFF	W-
30K - 3000K	24D - 24°	>90	2 - DALI	White
35K - 3500K	36D - 36°		3 - Phase	B-Black
40K - 4000K	50D - 50°		Dimming	
57K - 5700K				

Pluxb luminaires are developed with globally recognized and tested components suppliers, however as per international standards tolerance in initial flux and connected load is at $\pm 5\%$. Unless stated otherwise, the values apply to an ambient temperature of 25°C